

CORNER RECORD

Agency Index

BK 103 PG 43Document Number CR 10687City of DUBLIN APN: 941-2793-226County of ALAMEDA, CaliforniaBrief Legal Description PORTION OF TRACT 5511 AS FILED IN BOOK 163 OF MAPS, AT PAGES 48-58,
ALAMEDA COUNTY RECORDS.

CORNER TYPE

COORDINATES (Optional)

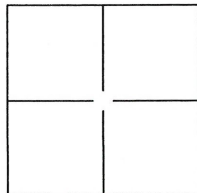

- ☐ Government Corner ☐ Control
☐ Meander ☐ Property
☐ Rancho ☒ Other

Date of Survey 9/19/17

N _____ E _____

Elevation _____

Units ☐ Metric ☒ U.S. Survey Foot

Horizontal Datum _____

Zone _____ Epoch Date _____

Vert. Datum: _____

☐ Complies with Public Resources Code §§8801-8819☐ Complies with Public Resources Code §§8890-8902PLS Act Ref.: ☐ 8765(d) ☒ 8771 ☐ 8773 ☐ Other:

Corner/
Monument: ☒ Left as found ☐ Established ☐ Rebuilt ☒ Pre-Construction
☐ Found and tagged ☐ Reestablished ☐ Referenced ☐ Post-Construction

Narrative of Corner identified and monument as found, set, reset, replaced or removed:

☐ See sheet #2 for description(s):

FOUND 2 1/2" BRASS DISK W/ PUNCH IN MONUMENT WELL STAMPED "CITY OF DUBLIN" AS PER MAP FILED
IN BOOK 163 OF MAPS, AT PAGES 48-58, ALAMEDA COUNTY RECORDS AT LOCATION IDENTIFIED ON PAGE 2
HEREIN.

SURVEYOR'S STATEMENT

This Corner Record was prepared by me or under my direction in conformance with
the Land Surveyors' Act on NOVEMBER 7, 2017,

Signed CURTIS C. CHAPPELL P.L.S. or R.C.E. Number 7992

COUNTY SURVEYOR'S STATEMENT

This Corner Record was received 11 OCTOBER, 2017 and
examined and filed 13 NOVEMBER, 2017

Signed Michael Rubner P.L.S. or R.C.E. No: 6843Title COUNTY SURVEYOR

County Surveyor's Comment _____



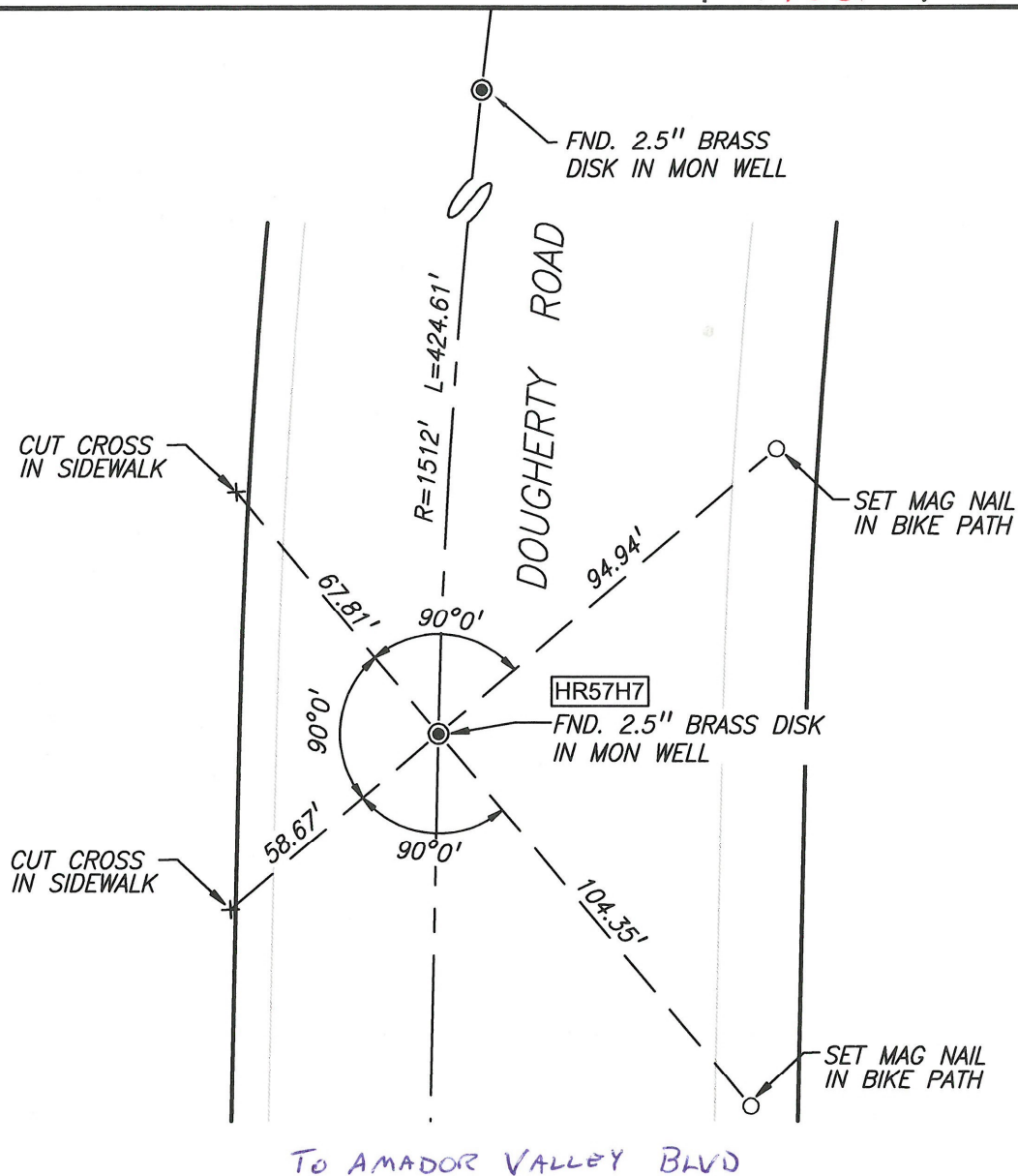

NOTES

- 1) ALL DISTANCES SHOWN HEREON ARE DISPLAYED IN U.S. SURVEY FEET AND DECIMALS THEREOF.

LEGEND

- ⊙ FOUND MONUMENT WELL W/ 2.5" BRASS DISK
- SET MAG NAIL
- × CUT CROSS AS NOTED
- XX##X# ALAMEDA COUNTY MONUMENT ID

