

CORNER RECORD

BK 93 PG 27

Document Number CR 9621

City of FREMONT

County of ALAMEDA, California

Brief Legal Description NORTHEASTERLY LINE OF LOT 30, TRACT 3594, PER BK. 93 OF MAPS, AT PG. 77

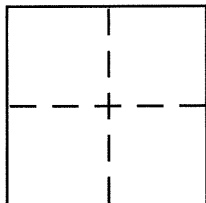

CORNER TYPE

Government Corner ☐ Control ☐
Meander ☐ Property ☒
Rancho ☐ Other ☐
Date of Survey DECEMBER 20, 2016

COORDINATES (Optional)

N. _____
E. _____
Zone _____ NAD27 ☐ NAD83 ☐
NAD83 Epoch _____
Elev. _____
Vert. Datum: NGVD29 ☐ NAVD88 ☐
Meas. Units: Metric ☐ Imperial ☐

Corner – Left as found ☐ Found and tagged ☐ Established ☒ Reestablished ☐ Rebuilt ☐

Identification and type of corner found: Evidence used to identify or procedure used to establish or reestablish the corner:

FOUND: 2.75" DIAMETER BRASS DISC WITH PUNCH IN MONUMENT WELLS IN RAINDEER COURT AND RAINDEER ROAD, STAMPED "CITY OF FREMONT", PER TRACT 3594 (BK. 93 MAPS, PG. 77)

SEE SKETCH ON PAGE 2 OF 2

A description of the physical condition of the monument as found and as set or reset:

SET: 1/2" DIAMETER REBAR WITH PLASTIC CAP "PLS 7393", AND NAIL & 3/4" BRASS TAG "PLS 7393"

SEE SKETCH ON PAGE 2 OF 2

SURVEYOR'S STATEMENT

This Corner Record was prepared by me or under my direction in conformance with the Land Surveyor's Act on JANUARY 03 2017

Signed K. Nofield P.L.S. or R.C.E. No. PLS 7393

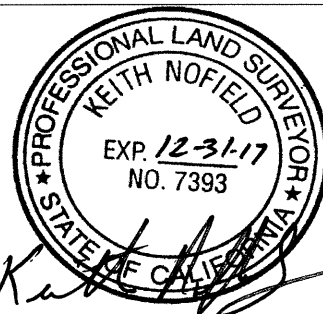

COUNTY SURVEYOR'S STATEMENT

This Corner Record was received 2 JANUARY, 2017

and examined and filed 6 MARCH, 2017

Signed Michael Rubner P.L.S. or R.C.E. No. 6843

Title COUNTY SURVEYOR

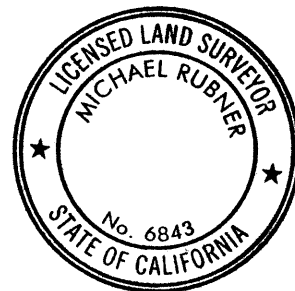

County Surveyor's Comment _____

