

CORNER RECORD

Document Number CR 5895
City of BERKELEY County of ALAMEDA, California

Brief Legal Description BRASS DISC CITY MONUMENT AND CUT CROSS LOCATED WITHIN OXFORD STREET. (CITY OF BERKELEY: B1522, B3540)

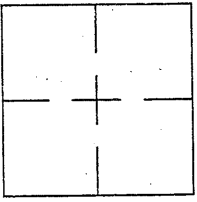

CORNER RECORD

Government Corner ☐ Control ☒
Meander ☐ Property ☐
Rancho ☐ Other ☐
Date of Survey 10/16/13

COORDINATES
(Optional)

N. _____
E. _____
Zone _____ Datum _____
Elev. _____

Corner — Left as found ☒ Found and tagged ☐ Established ☐ Reestablished ☐ Rebuilt ☐

Identification and type of corner found: Evidence used to identify or procedure used to establish or reestablish the corner:
FOUND BRASS DISC CITY MONUMENT AND CUT CROSS IN THE TOP OF CURB LOCATED
WITHIN OXFORD STREET.
(REFERENCE ADDRESS: 831)

THIS POINT WAS REFERENCED PRIOR TO A CONSTRUCTION PROJECT IN THE VICINITY.

A description of the physical condition of the monument as found and as set or reset:
FOUND AND SET POINTS AS SHOWN ON PAGE 2.

THESE TIES ARE FOR THE PURPOSE OF PERPETUATING THE FOUND MONUMENTATION.
NO CLAIM IS MADE AS TO THE RELATIONSHIP OF THE POINTS OR LINES SHOWN HEREON
TO TRUE BOUNDARY LOCATIONS.

SURVEYOR'S STATEMENT

This Corner Record was prepared by me or under my direction in conformance with
the Land Surveyors' Act on OCTOBER 18, 2013.
Signed Vincent H. Cunha L.S. Number LS 4520

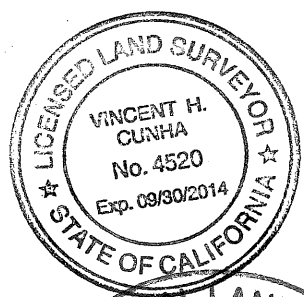

COUNTY SURVEYOR'S STATEMENT

This Corner Record was received 10-21-2013 and examined
and filed 11-24-2013.
Signed Russell R. Penland Title County Surveyor

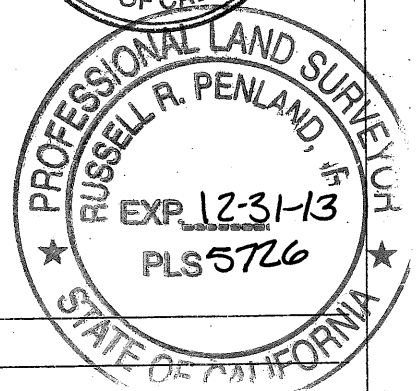

County Surveyor's Comment _____



SCALE: 1"=10'

LEGEND

- FOUND BRASS DISC CITY MONUMENT
- ⊗ FOUND CUT CROSS IN TOP OF CURB
- ✕ SET CUT CROSS IN CONCRETE
- C.O.B. CITY OF BERKELEY
- AA##A# ALAMEDA COUNTY MONUMENT ID

