

CORNER RECORD

City of BERKELEY

Document Number CR 3871

County of ALAMEDA, California

Brief Legal Description CITY MONUMENT B0030

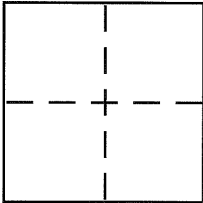

CORNER TYPE

Government Corner ☐ Control ☒
Meander ☐ Property ☐
Rancho ☐ Other ☐
Date of Survey 7-23-09

COORDINATES (Optional)

N. _____
E. _____
Zone _____ NAD27 ☐ NAD83 ☐
NAD83 Epoch _____
Elev. _____
Vert. Datum: NGVD29 ☐ NAVD88 ☐
Meas. Units: Metric ☐ Imperial ☐

Corner - Left as found ☒ Found and tagged ☐ Established ☐ Reestablished ☐ Rebuilt ☐

Identification and type of corner found: Evidence used to identify or procedure used to establish or reestablish the corner:

MONUMENT REFERENCE, SEE PAGE 2

A description of the physical condition of the monument as found and as set or reset:

SEE PAGE 2

SURVEYOR'S STATEMENT

This Corner Record was prepared by me or under my direction in conformance with the Land Surveyor's Act on JULY 31 2009

Signed [Signature] P.L.S or R.C.E. No. PLS 5003

COUNTY SURVEYOR'S STATEMENT

This Corner Record was received 8-18-09
and examined and filed 9-9-09

Signed [Signature] P.L.S or R.C.E. No. 5726

Title COUNTY SURVEYOR

County Surveyor's Comment _____

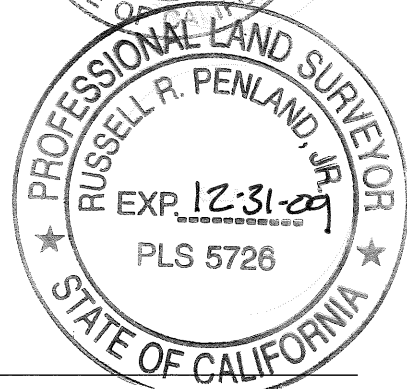
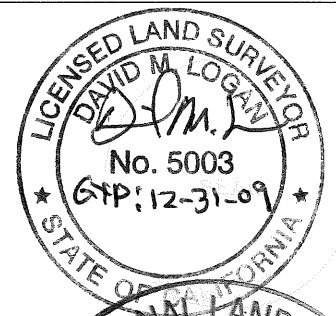



SCALE: 1"=30'

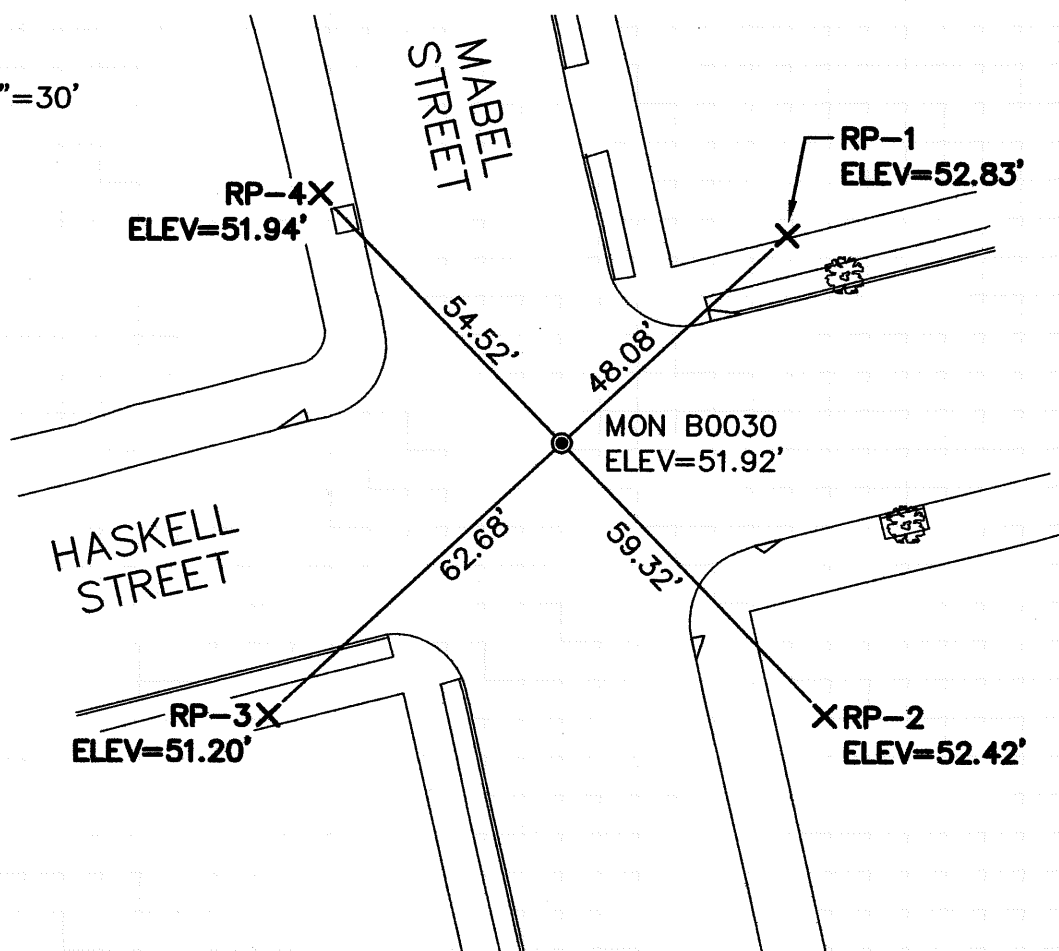

LEGEND

⊙ STANDARD WELL-TYPE CITY MONUMENT
WITH TWO 3/8" BRASS PINS. THE PIN
REFERENCED IS THE SOUTH PIN - B0030

+ REFERENCE CROSS ON SIDEWALK

NOTE:

THE EXISTING MONUMENT AS SHOWN IS REFERENCED
BY STRAIGHT LINES BETWEEN RP-1 TO RP-3 AND
RP-2 TO RP-4.