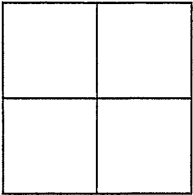

## CORNER RECORD

 BK 50 PG 61  
 Document Number CR 5494  
 City of OAKLAND County of ALAMEDA, California

 Brief Legal Description BRASS DISC MONUMENT LOCATED WITHIN THE INTERSECTION OF GRIZZLY PEAK BOULEVARD BOULEVARD AND SKYLINE BOULEVARD. (CCC SA32)

## CORNER RECORD

 Government Corner ☐ Control ☒  
 Meander ☐ Property ☐  
 Rancho ☐ Other ☐  
 Date of Survey 4/15/13
COORDINATES  
(Optional)
 N. 2135575 ±1'  
 E. 6070596 ±1'  
 Zone \_\_\_\_\_ Datum \_\_\_\_\_  
 Elev. \_\_\_\_\_

 Corner — Left as found ☒ Found and tagged ☐ Established ☐ Reestablished ☐ Rebuilt ☐

 Identification and type of corner found: Evidence used to identify or procedure used to establish or reestablish the corner:  
FOUND BRASS DISC MONUMENT LOCATED WITHIN THE INTERSECTION OF GRIZZLY PEAK
BOULEVARD AND SKYLINE BOULEVARD.
AS SHOWN ON CITY OF OAKLAND MONUMENT MAP, PAGE 326.
THIS POINT WAS REFERENCED PRIOR TO A CONSTRUCTION PROJECT IN THE VICINITY.

A description of the physical condition of the monument as found and as set or reset:

FOUND AND SET POINTS AS SHOWN ON PAGE 2.
THESE TIES ARE FOR THE PURPOSE OF PERPETUATING THE FOUND MONUMENTATION.
NO CLAIM IS MADE AS TO THE RELATIONSHIP OF THE POINTS OR LINES SHOWN HEREON TO TRUE BOUNDARY LOCATIONS.

## SURVEYOR'S STATEMENT

 This Corner Record was prepared by me or under my direction in conformance with  
 the Land Surveyors' Act on APRIL 23, 2013.

 Signed Vincent H. Cunha L.S. Number LS 4520  
 VINCENT H. CUNHA

## COUNTY SURVEYOR'S STATEMENT

 This Corner Record was received 4-26-13 and examined

 and filed 7-10-2013

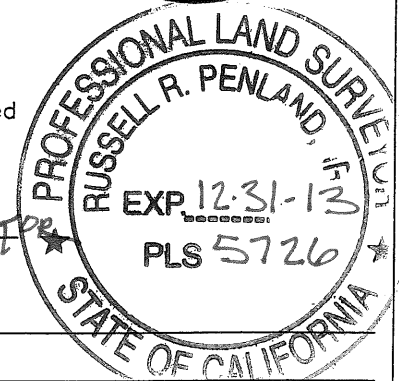
 Signed Russell R. Penland Title COUNTY SURVEYOR

County Surveyor's Comment \_\_\_\_\_



SCALE: 1"=30'

### LEGEND

- FOUND BRASS DISC IN MONUMENT WELL (CCC<sub>o</sub> SA32)
- ⊙ FOUND IRON PIN IN MONUMENT WELL (POST 29)
- SET 1/2" REBAR & BLANK CAP

CONTRA COSTA COUNTY  
CITY OF OAKLAND

GRIZZLY PEAK  
BOULEVARD

SKYLINE  
BOULEVARD

