

CORNER RECORD

Agency Index

BK 146 PG 100

Document Number CR 15981

City of BERKELEY

County of ALAMEDA

, California

Brief Legal Description FOUND BRASS DISK AT THE INTERSECTION OF GRAYSON STREET AND SAN PABLO AVENUE, BERKELEY, CA.

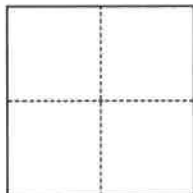
CORNER TYPE**COORDINATES (Optional)**

- ☐ Government Corner ☒ Control
☐ Meander ☐ Property
☐ Rancho ☐ Other

N. _____ E. _____

Elevation _____

Units ☐ Metric ☒ U.S. Survey Foot

Horizontal Datum _____

Zone _____ Epoch Date _____

Vertical Datum _____

☐ Complies with Public Resources Code §§8801-8819☐ Complies with Public Resources Code §§8890-8902

PLS Act Ref.:

☐ 8765(d)☒ 8771☐ 8773☐ Other:Corner/
Monument:☒ Left as found☐ Established☐ Rebuilt☒ Pre-Construction☐ Found and tagged☐ Reestablished☒ Referenced☐ Post-Construction

Narrative of corner identified and monument as found, set, reset, replaced, or removed:

☐ See sheet #2 for description(s):

FOUND CITY MONUMENT B0213, A 2-5/8" DIAMETER, ALAMEDA COUNTY SURVEYOR BRASS DISK, WITH TWO PUNCH MARKS, AND HOLDING THE MOST EASTERLY PUNCH, 0.7 FEET DEEP, IN MONUMENT WELL AT THE INTERSECTION ON GRAYSON STREET AND SAN PABLO AVENUE, AS SHOWN ON THAT CERTAIN PARCEL MAP 10616, IN BOOK 336 OF MAPS, AT PAGES 57-61, ALAMEDA COUNTY RECORDS.

THIS MONUMENT HAS BEEN REFERENCED PRIOR TO CONSTRUCTION.

THE TIES SHOWN HEREON ARE FOR THE PURPOSE OF PERPETUATING FOUND MONUMENTS, AND NO CLAIM IS MADE TO THEIR RELATIONSHIP TO THE BOUNDARY LOCATION SHOWN HEREON.

SURVEYOR'S STATEMENT

This Corner Record was prepared by me or under my direction in conformance with

the Professional Land Surveyors' Act on MARCH 3, 2022

Signed

(P.L.S.) or R.C.E. No.

8965

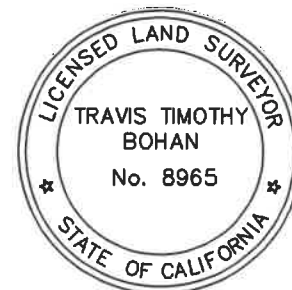
**COUNTY SURVEYOR'S STATEMENT**

This Corner Record was received

and examined and filed

APRIL 15 2022

Signed

(P.L.S.) or R.C.E. No.

7010

Title ALAMEDA COUNTY SURVEYOR

County Surveyor's Comment

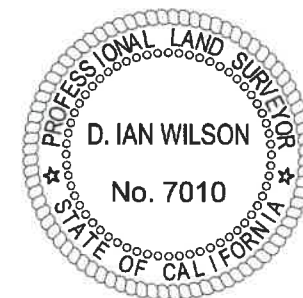

**LEGEND**

- APPROXIMATE LOT LINE
- — — MONUMENT TIE LINE
- FOUND CITY MONUMENT, A 2-5/8" DIA
ALAMEDA COUNTY SURVEYOR BRASS DISK,
PER 336 PM 57
- SET BRASS TAG & RIVET LS 8965
IN TOP OF CONCRETE CURB.
- PM PARCEL MAP
- () RECORD DATA PER 336 PM 57

