

ISSUED FOR BID - NOT FOR CONSTRUCTION 4/25/22

NOTE:
PROVIDE 2" 6" X 2" 6" LEAVE OUT
AROUND FLOOR SINK SHOWN TO
ALLOW FOR FINAL ADJUSTMENT.
PROVIDE #3 DOWELS @ 12" O.C.
AROUND PERIMETER. (THESE 2
SINKS ONLY)

NOTE:
DIMENSIONS TO FACE OF SLAB, UNLESS NOTED OTHERWISE
ROUGH IN DIMENSIONS SHOULD BE HELD FROM OUTSIDE FACE OF SLAB
DIMENSIONS PROVIDED TO FLOOR SINK FROM INTERIOR WALL SHOULD
BE FOR FINAL REFERENCE ONLY
PANDA PM TO VERIFY THE LOCATIONS OF SINK FLOOR DRAINS

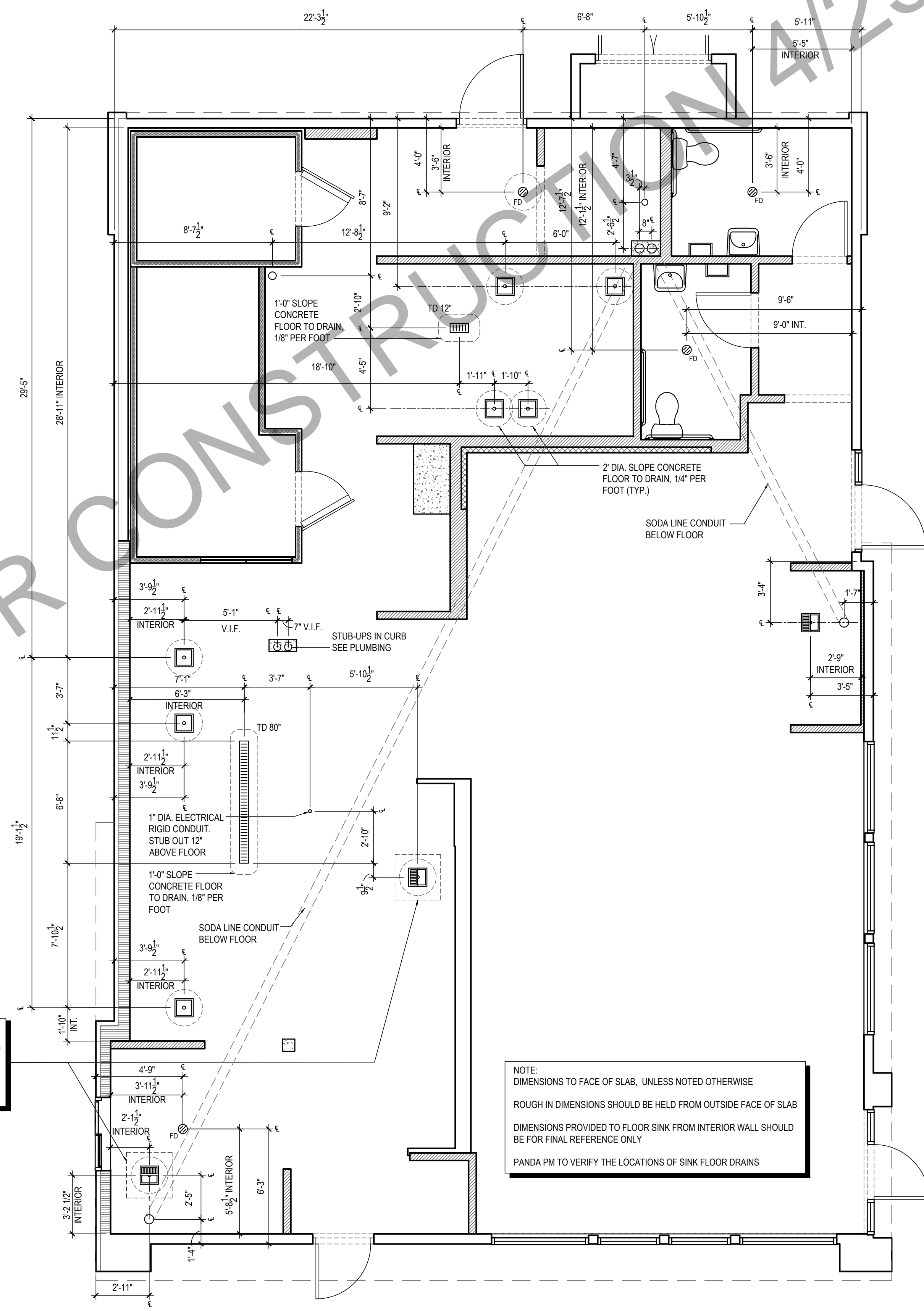

PANDA RESTAURANT GROUP INC.
1683 Walnut Grove Ave.
Rosemead, California
91770
Telephone: 626.799.9898
Facsimile: 626.372.8288

All ideas, designs, arrangement and plans indicated or represented by this drawing are the property of Panda Express Inc. and were created for use on this specific project. None of these ideas, designs, arrangements or plans may be used by or disclosed to any person, firm, or corporation without the written permission of Panda Express Inc.

REVISIONS:

ISSUE DATE:

1	01.25.2022 ISSUE FOR PERMIT

DRAWN BY: KT

PANDA PROJECT #: - D8638
C&P PROJECT #: - 2210869



2600 Maitland Center Parkway
Suite #200
Maitland, FL 32751
P (407) 661-9100
F (407) 661-9101
c-p.com

01.25.2022

PANDA EXPRESS

TRUE WARM & WELCOME 2500
2406 NORTH MAIN STREET
HIGH POINT, NC 27262

A-102

ROUGH - IN PLUMBING PLAN

TRUE WARM & WELCOME 2500 R2

NOT USED 3
Scale= 1 1/2" = 1'-0" A-102

NOT USED 2
Scale= 1 1/2" = 1'-0" A-102

ROUGH - IN PLUMBING PLAN 1
Scale= 1/4" = 1'-0" A-102